

▼ DIMENSIONS and WEIGHTS

SIZE	DIMENSIONS LISTED IN INCHES (In Millimeters)									HOOD LENGTH		WGT
	A	B	C	D	E	F	G	H	J	Intake	Exhaust	Lbs.(Kg)
01	49 (1247)	32 (813)	32 (813)	7-1/8 (181)	8-1/2 (216)	8 (203)	10 (254)	8 (203)	10 (254)	12-1/2 (318)	14-1/4 (362)	550 (249)
02	58 (1473)	46 (1168)	38 (965)	9-3/8 (238)	10-1/2 (267)	14 (356)	14 (356)	14 (356)	14 (356)	18-1/4 (464)	18-1/4 (464)	950 (431)
03	70 (1778)	54 (1372)	49 (1247)	12-1/2 (318)	13-3/4 (349)	18 (457)	18 (457)	18 (457)	18 (457)	21 (534)	20-1/4 (515)	1200 (544)
04	72 (1829)	54 (1372)	55-1/2 (1410)	18 (457)	18 (457)	18 (457)	18 (457)	18 (457)	24 (610)	28-1/2 (724)	20-1/4 (514)	2000 (907)
06	80 (2032)	72 (1829)	67-1/2 (1715)	24 (610)	20 (508)	24 (610)	20 (508)	22 (559)	26 (660)	34-1/2 (876)	24-3/4 (629)	2400 (1089)
08	87-1/2 (2223)	78 (1981)	72-1/2 (1842)	24 (610)	24 (610)	24 (610)	24 (610)	28 (711)	34 (864)	34-1/2 (876)	24-3/4 (629)	2500 (1134)

UNIT ARRANGEMENT # 1

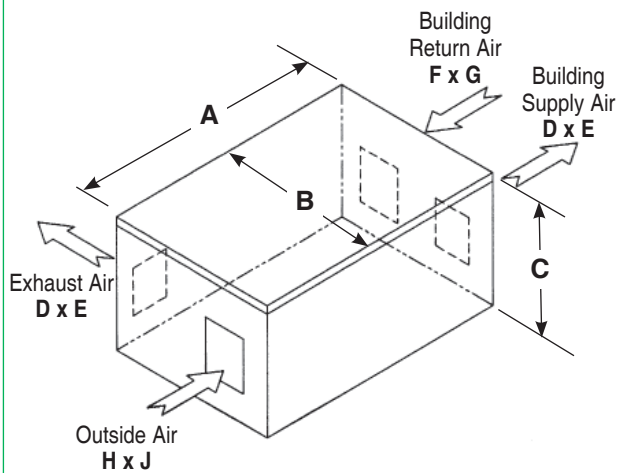

UNIT ARRANGEMENT # 2

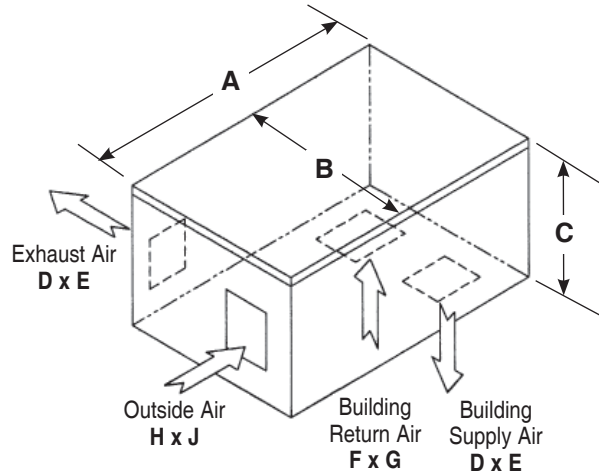

UNIT ARRANGEMENT # 6

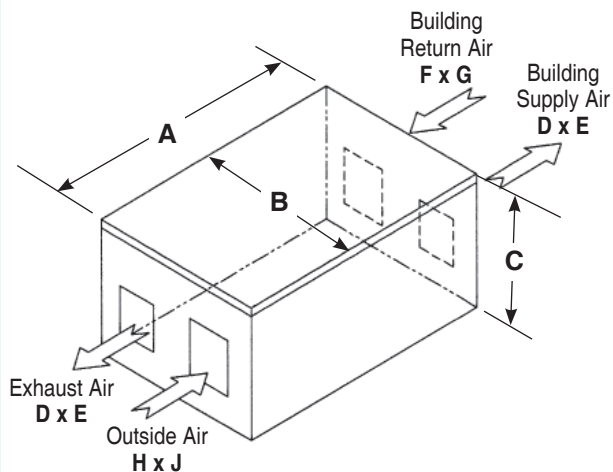

UNIT ARRANGEMENT # 7

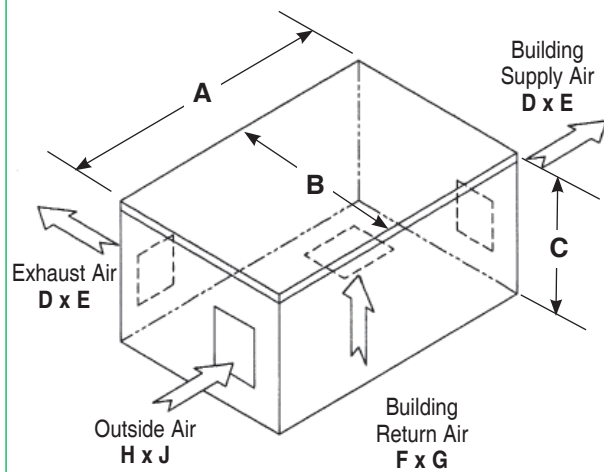

▼ CURB & ROOF OPENING

DIMENSIONS LISTED IN INCHES (IN MILLIMETERS)									
SIZE	A	B	C	D	E	F	G	H	J
01	47 (1194)	30 (762)	7-1/8 (181)	8-1/2 (216)	3-1/8 (79)	8 (203)	10 (254)	6 (152)	2-1/4 (57)
02	56 (1422)	44 (1118)	9-3/8 (238)	10-1/2 (267)	5-7/8 (149)	14 (356)	14 (356)	6-1/2 (165)	2-1/4 (57)
03	68 (1727)	52 (1321)	12-1/2 (318)	13-3/4 (349)		18 (457)	18 (457)	6-1/2 (165)	2-1/4 (57)
04	69 (1753)	51 (1295)	18 (457)	18 (457)	3 (76)	18 (457)	18 (457)	3 (76)	
06	77 (1956)	69 (1753)	24 (610)	20 (508)	5 (127)	24 (610)	20 (508)	5 (127)	2-1/2 (64)
08	84-1/2 (2070)	75 (1905)	24 (610)	24 (610)	6-1/4 (159)	24 (610)	24 (610)	6-1/4 (159)	2-1/2 (64)

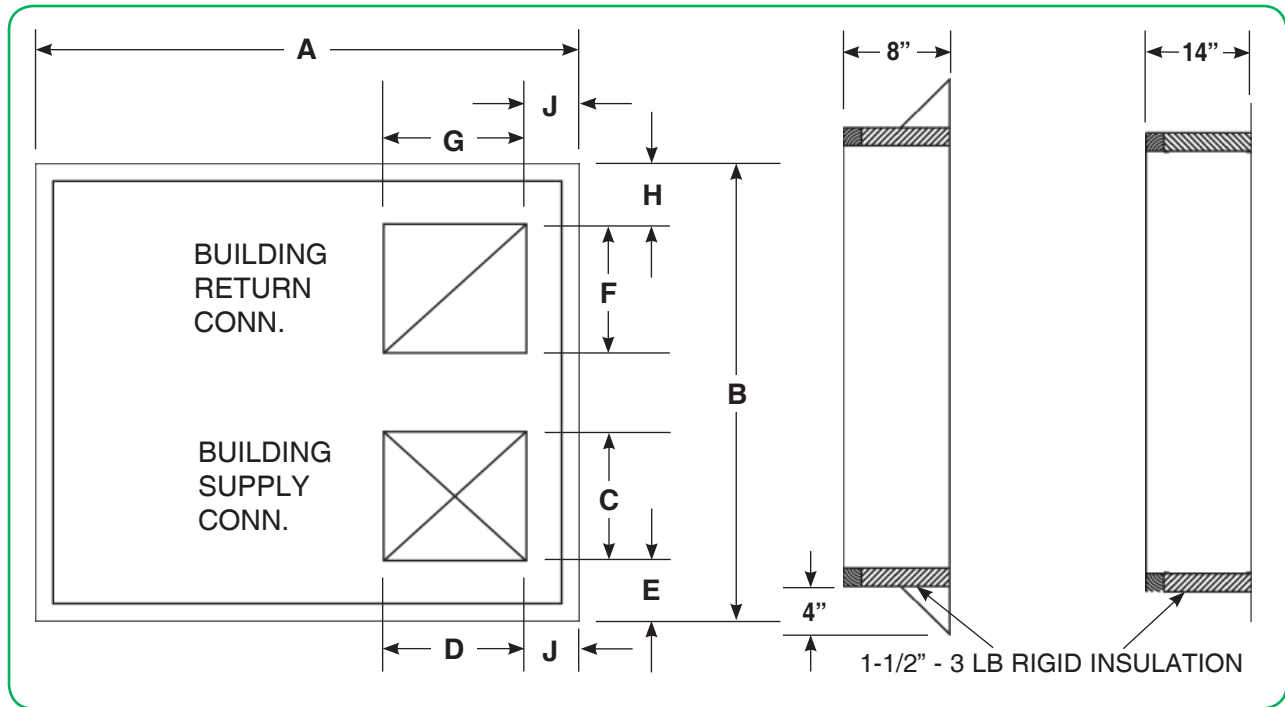

SIZE	SERVICE CLEARANCE		FILTERS QTY AND SIZE
	SUPPLY SIDE	EXHAUST	
01	32 (813)	30 (762)	2 - 12 x 20 x 2 (305 x 508 x 51)
02	46 (1168)	32 (813)	2 - 16 x 25 x 2 (406 x 635 x 51)
03	54 (1372)	42 (1067)	4 - 18 x 20 x 2 (457 x 508 x 51)
04	54 (1372)	42 (1067)	4 - 24 x 24 x 2 (610 x 610 x 51)
06	72 (1829)	42 (1067)	12 - 16 x 20 x 2 (406 x 508 x 51)
08	78 (1981)	42 (1067)	8 - 16 x 25 x 2 (406 x 635 x 51)
			4 - 20 x 25 x 2 (508 x 635 x 51)

Integral Control Panel mounted inside return air plenum.