

### IP [English] DIMENSIONS (SI Metric) In Parentheses

CARNES COMPANY 448 S. Main St., P. O. Box 930040, Verona, WI 53593-0040 Phone: (608)845-6411 Fax: (608)845-6504 www.carnes.com

#### For Use With Models H\_GH, H\_HH

#### Lengths 012-036

- Suitable for capacities up to 30 lbs./hr.
- Machined from high quality 304 B stainless steel.
- Steam is dispersed through evenly spaced outlet orifices.
- The length selection of the distribution pipe is defined by the duct width.

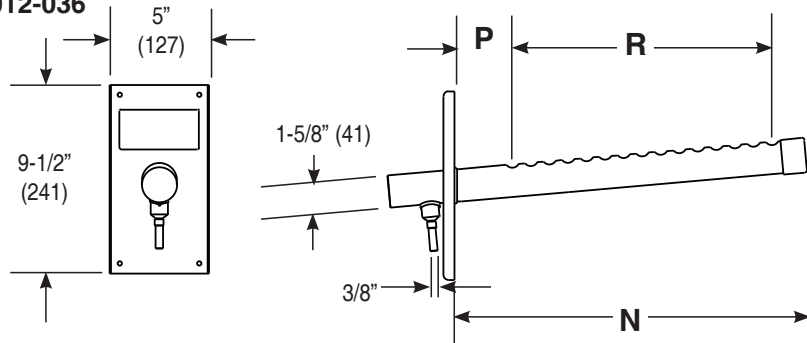

MODEL	N	P	R
HXPBC012S	11-13/16" (300mm)	1-1/4" (32mm)	8-3/4" (222mm)
HXPBC018S	17-13/16" (452mm)	2-7/8" (73mm)	13-1/8" (333mm)
HXPBC024S	23-13/16" (605mm)	2-3/4" (70mm)	19-1/4" (489mm)
HXPBC030S	29-13/16" (757mm)	2-5/8" (67mm)	25-3/8" (645mm)
HXPBC036S	35-13/16" (910mm)	2-1/2" (64mm)	31-1/2" (800mm)

#### Lengths 048-120

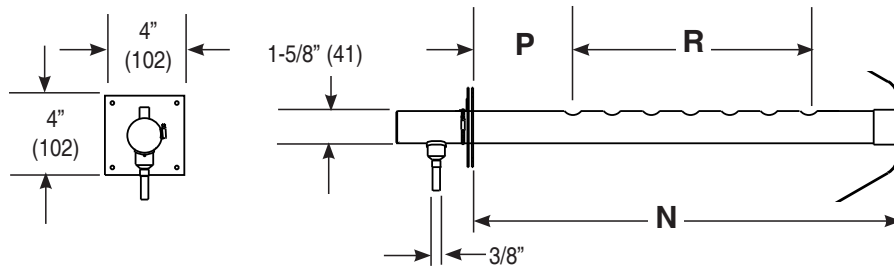

MODEL	MAXIMUM*		MINIMUM*		R
	P	N	P	N	
HXPBC048S	8" (203mm)	46" (1168mm)	5" (127mm)	43" (1092mm)	32-1/2" (826mm)
HXPBC060S	8" (203mm)	58" (1473mm)	5" (127mm)	55" (1397mm)	43-3/4" (1111mm)
HXPBC072S	8" (203mm)	70" (1778mm)	5" (127mm)	67" (1702mm)	56-1/4" (1429mm)
HXPBC084S	8" (203mm)	82" (2083mm)	5" (127mm)	79" (2007mm)	67-1/2" (1714mm)
HXPBC096S	8" (203mm)	94" (2388mm)	5" (127mm)	91" (2311mm)	80" (2032mm)
HXPBC108S	8" (203mm)	106" (2692mm)	5" (127mm)	103" (2616mm)	92-1/2" (2350mm)
HXPBC120S	8" (203mm)	118" (2997mm)	5" (127mm)	115" (2921mm)	103-3/4" (2635mm)

\*The mounting plate on these pipes is adjustable. The "P" and "N" dimensions are shown at both maximum and minimum depending on position of mounting plate. An infinite variety of settings are available between the minimum and maximum.

MATERIAL: Stainless steel