

## Extruded Aluminum Double Drainable Blade Louver 4" Deep

Model: FPMB Channel Frame, FTMB Flanged Frame

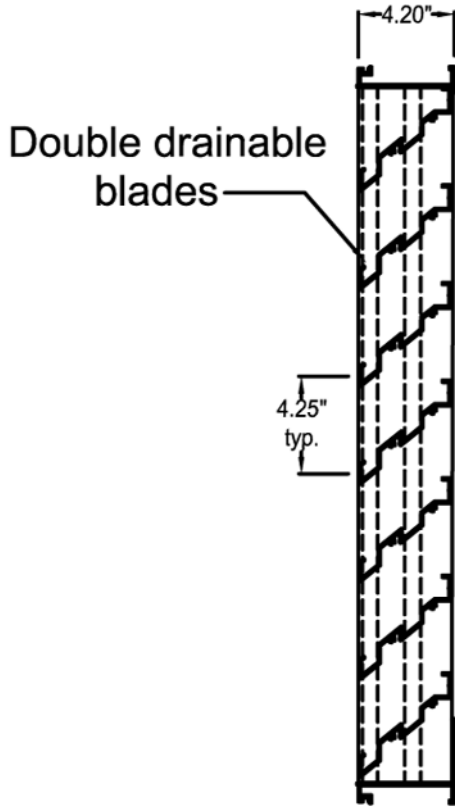

Section View

### Model FPMB

#### ▼ Standard Specifications

**Frame:** .081 extruded aluminum, 4.20" deep

**Blades:** .094 extruded aluminum positioned on a 39° angle on approximately 4.25" centers

**Finish:** mill aluminum (standard)

**Screen:** 3/4" x .051" flattened aluminum in removable frame. Screen is mounted as standard on inside (rear) as looking from exterior of building.

**Maximum Panel Size:** 84"w x 120"h or 120"w x 84"h

**Minimum Panel Size:** 9"w x 9"h

**Note:** Drainable blade louvers should be limited to 10' maximum section widths (no more than 10' between vertical downspouts) to enable the drainable design to function effectively.

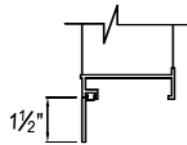

Flanged Frame  
Optional

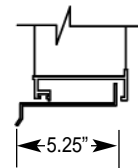

Extended Sill  
Optional

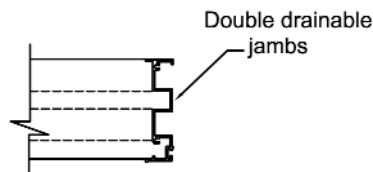
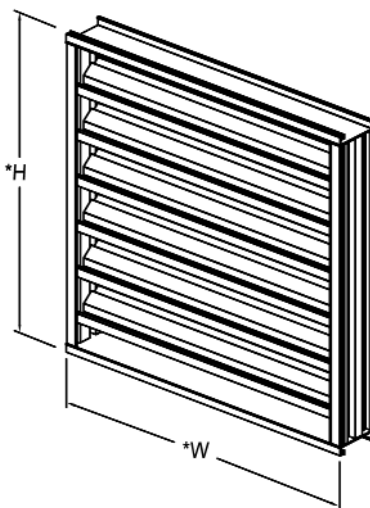

Plan View

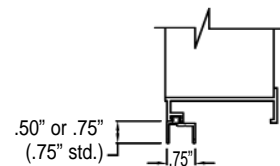

Glazing Adapter  
Optional

\*Width and height dimensions are approximately 1/4" under listed size.



The Carnes Company certifies that the model FPMB/FTMB louver shown herein is licensed to bear the AMCA Seal. The ratings shown are based on tests and procedures performed in accordance with AMCA Publication 511 and comply with the requirements of the AMCA Certified Ratings Program. The AMCA Certified Ratings Seal applies to air performance ratings and water penetration ratings.

## Model FPMB and FTMB

Free Area in Square Feet

| HEIGHT INCHES | WIDTH IN INCHES |      |      |       |       |       |       |       |       |       |       |       |       |       |       |       |       |       |       |
|---------------|-----------------|------|------|-------|-------|-------|-------|-------|-------|-------|-------|-------|-------|-------|-------|-------|-------|-------|-------|
|               | 12              | 18   | 24   | 30    | 36    | 42    | 48    | 54    | 60    | 66    | 72    | 78    | 84    | 90    | 96    | 102   | 108   | 114   | 120   |
| 12            | 0.28            | 0.45 | 0.63 | 0.80  | 0.97  | 1.15  | 1.32  | 1.49  | 1.67  | 1.84  | 2.01  | 2.18  | 2.36  | 2.53  | 2.70  | 2.88  | 3.05  | 3.22  | 3.40  |
| 18            | 0.44            | 0.71 | 0.97 | 1.24  | 1.51  | 1.78  | 2.05  | 2.32  | 2.59  | 2.86  | 3.13  | 3.39  | 3.66  | 3.93  | 4.20  | 4.47  | 4.74  | 5.01  | 5.28  |
| 24            | 0.56            | 0.91 | 1.25 | 1.60  | 1.94  | 2.28  | 2.63  | 2.97  | 3.32  | 3.66  | 4.01  | 4.35  | 4.70  | 5.04  | 5.39  | 5.73  | 6.08  | 6.42  | 6.77  |
| 30            | 0.85            | 1.37 | 1.89 | 2.41  | 2.93  | 3.45  | 3.98  | 4.50  | 5.02  | 5.54  | 6.06  | 6.58  | 7.11  | 7.63  | 8.15  | 8.67  | 9.19  | 9.71  | 10.23 |
| 36            | 1.00            | 1.62 | 2.24 | 2.86  | 3.47  | 4.09  | 4.71  | 5.33  | 5.94  | 6.56  | 7.18  | 7.80  | 8.41  | 9.03  | 9.65  | 10.27 | 10.88 | 11.50 | 12.12 |
| 42            | 1.32            | 2.14 | 2.95 | 3.76  | 4.58  | 5.39  | 6.20  | 7.02  | 7.83  | 8.64  | 9.46  | 10.27 | 11.08 | 11.90 | 12.71 | 13.52 | 14.34 | 15.15 | 15.96 |
| 48            | 1.48            | 2.39 | 3.30 | 4.21  | 5.12  | 6.03  | 6.94  | 7.85  | 8.76  | 9.67  | 10.58 | 11.49 | 12.40 | 13.31 | 14.21 | 15.12 | 16.03 | 16.94 | 17.85 |
| 54            | 1.61            | 2.59 | 3.58 | 4.57  | 5.56  | 6.54  | 7.53  | 8.52  | 9.51  | 10.50 | 11.48 | 12.47 | 13.46 | 14.45 | 15.43 | 16.42 | 17.41 | 18.40 | 19.39 |
| 60            | 1.89            | 3.05 | 4.21 | 5.37  | 6.54  | 7.70  | 8.86  | 10.02 | 11.18 | 12.35 | 13.51 | 14.67 | 15.83 | 17.00 | 18.16 | 19.32 | 20.48 | 21.64 | 22.81 |
| 66            | 1.90            | 3.06 | 4.23 | 5.40  | 6.57  | 7.73  | 8.90  | 10.07 | 11.24 | 12.40 | 13.57 | 14.74 | 15.91 | 17.07 | 18.24 | 19.41 | 20.58 | 21.74 | 22.91 |
| 72            | 2.19            | 3.53 | 4.88 | 6.22  | 7.57  | 8.92  | 10.26 | 11.61 | 12.95 | 14.30 | 15.64 | 16.99 | 18.34 | 19.68 | 21.03 | 22.37 | 23.72 | 25.06 | 26.41 |
| 78            | 2.35            | 3.79 | 5.24 | 6.68  | 8.12  | 9.57  | 11.01 | 12.46 | 13.90 | 15.35 | 16.79 | 18.24 | 19.68 | 21.12 | 22.57 | 24.01 | 25.46 | 26.90 | 28.35 |
| 84            | 2.65            | 4.28 | 5.91 | 7.54  | 9.17  | 10.80 | 12.44 | 14.07 | 15.70 | 17.33 | 18.96 | 20.59 | 22.22 | 23.85 | 25.48 | 27.11 | 28.74 | 30.38 | 32.01 |
| 90            | 2.82            | 4.56 | 6.30 | 8.03  | 9.77  | 11.51 | 13.24 | 14.98 | 16.72 | 18.46 | 20.19 | 21.93 | 23.67 | 25.40 | 27.14 | 28.88 | 30.61 | 32.35 | 34.09 |
| 96            | 2.94            | 4.75 | 6.56 | 8.37  | 10.18 | 11.99 | 13.80 | 15.61 | 17.42 | 19.23 | 21.04 | 22.85 | 24.67 | 26.48 | 28.29 | 30.10 | 31.91 | 33.72 | 35.53 |
| 102           | 3.23            | 5.22 | 7.21 | 9.20  | 11.19 | 13.18 | 15.16 | 17.15 | 19.14 | 21.13 | 23.12 | 25.11 | 27.10 | 29.09 | 31.07 | 33.06 | 35.05 | 37.04 | 39.03 |
| 108           | 3.39            | 5.47 | 7.55 | 9.64  | 11.72 | 13.80 | 15.89 | 17.97 | 20.05 | 22.14 | 24.22 | 26.31 | 28.39 | 30.47 | 32.56 | 34.64 | 36.72 | 38.81 | 40.89 |
| 114           | 3.50            | 5.65 | 7.80 | 9.95  | 12.10 | 14.25 | 16.41 | 18.56 | 20.71 | 22.86 | 25.01 | 27.16 | 29.32 | 31.47 | 33.62 | 35.77 | 37.92 | 40.07 | 42.23 |
| 120           | 3.67            | 5.93 | 8.19 | 10.45 | 12.71 | 14.97 | 17.23 | 19.49 | 21.75 | 24.00 | 26.26 | 28.52 | 30.78 | 33.04 | 35.30 | 37.56 | 39.82 | 42.08 | 44.34 |

Beginning point of WATER PENETRATION is 1157 fpm  
free area velocity at .01 oz. of water penetration

### Pressure Drop

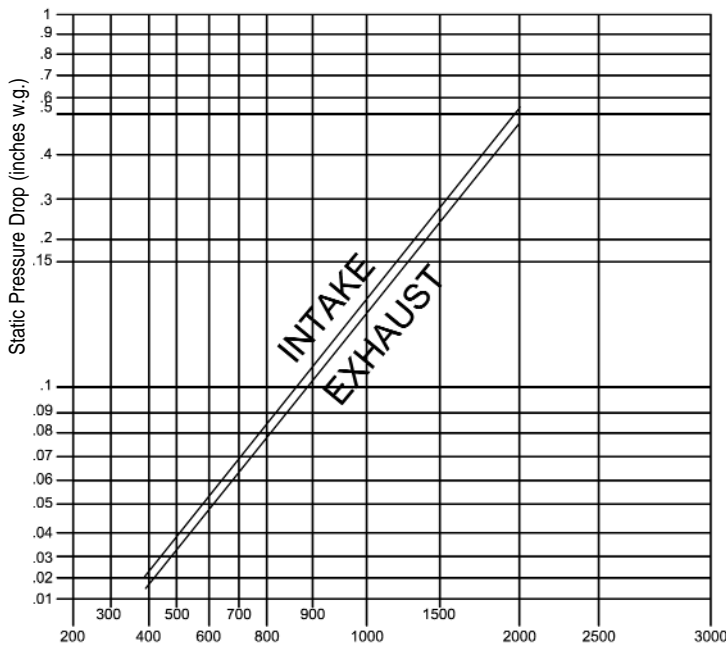

### FREE AREA VELOCITY (FT/MIN)

Standard air - .075 lbs per cu ft  
Ratings do not include the effects of a wire birdscreen  
Test based on a 48" x 48" test size, 15 min test duration

### Water Penetration

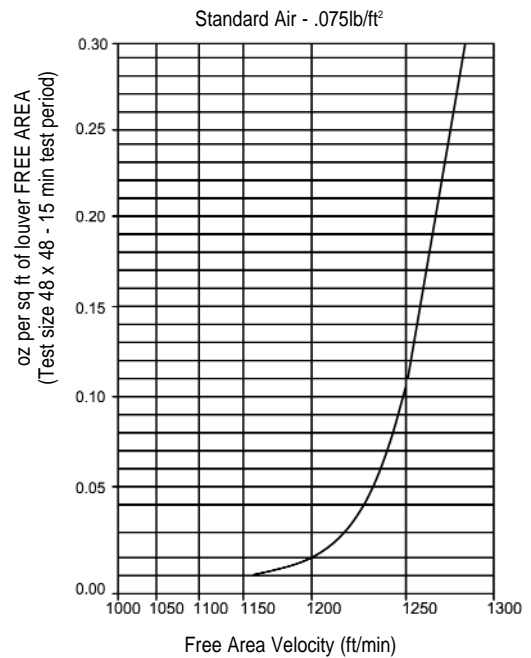

Drainable Blade